

4D3N BALI/ NUSA PENIDA/ NUSA LEMBONGAN (New)



Klingking Beach – Nusa Penida

INDONESIA

FROM RM **1700** pp

TRAVEL VALIDITY **2019**
JAN15 – MAR31

Booking by Mar25

- Price Per Person in RM
- Daily Departure
- Minimum 02 Adults
- Land Tour Package Only

PRICE INCLUSIONS

- ✓ Return private transfer airport-hotel
- ✓ 2 nights in Bali and 1 night in Nusa Penida with daily breakfast
- ✓ Lunch & dinner at local restaurant
- ✓ Small transport in Nusa Penida
- ✓ Sightseeing by public transport (open air car) in Nusa Lembongan
- ✓ Speedboat based on sit-in-boat basis
- ✓ Sightseeing as per itinerary with local station English speaking guide
- ✓ Gratuities to driver & guide

PRICE EXCLUSIONS

- ✗ Airfare & applicable airport taxes
- ✗ Personal Incidental Expenses
- ✗ Optional Tours

REMARKS

- ❖ Tour prices and itinerary quoted are subject to change
- ❖ Valid for **Malaysian passport holder** only
- ❖ Peak season surcharge may apply (To be advised upon booking)
- ❖ Subject to room availability
- ❖ No refund for un-utilized tours
- ❖ Terms & Conditions Apply

VISA

Tourist visa is not required for Malaysia passport holder for a stay up to 90days

TRAVEL INSURANCE



Travel Insurance provider:
AIG Malaysia Insurance Berhad

Room (or similar)	Adult			Child [2-11Yrs]		Extension Night with Breakfast Per Room Night		
	Twin Share	Triple Share	Single Room	Extra Bed	No Bed	Single/ Twin	Triple Share	Child No Bed
4★ PARK REGIS (KUTA)								
Regis	1700	1630	2010	1460	880	220	330	70
4★ RHADANA, Muslim Hotel (KUTA)								
Business Room	1730	NA	2050	1480	890	250	NA	70
4★ GRAND IXORA KUTA (KUTA)								
Superior	1750	1670	2090	1490	900	250	350	70
5★ BALI DYNASTY RESORT (KUTA)								
Superior	2290	2220	3220	1960	1180	650	960	80
Block-out date: Mar06-07, 2019 (Nyepi Festival/ Silent Day) Peak Season and festival season – surcharge to be advised								

NUSA PENIDA

3★-Ring Sameton Resort or similar

DAY ITINERARY

- 01 BALI – ARRIVAL (Dinner)**
Arrive Bali Airport, (Exit International arrival gate), meet and greet by airport representative. Transfer to hotel for check-in. Afternoon, transfer to **Uluwatu Temple**, admire sunset at the cliff of Uluwatu Temple. Enjoy **Balinese Traditional Dance at GWK Cultural Park**. After dinner, discover the majestic statue of **Garuda Wisnu Kencana**. Explore the night life at **Legian Steet** (Drop-off only). Own arrangement back to hotel.
- 02 BALI – NUSA PENIDA (Breakfast /Lunch/Dinner)**
At 6.00am, transfer to Sanur Beach. Take a 45minutes speedboat ride to **Nusa Penida**. Arrive at Toya Pakeh Harbour, meet and greet by local tour guide. Then transfer to western coast of Nusa Penida. Explorer the beauty of **Angel Bilabong** and **Broken Beach**. After lunch, transfer to **Klingking Beach** which overlooking Indian Ocean. Then, enjoy swimming and sun bathing at **Crystal Bay**. Transfer to hotel to check-in.
- 03 NUSA PENIDA – NUSA LEMBONGAN - BALI (Breakfast /Lunch/Dinner)**
Morning transfer to Toya Pakeh Habor and take a boat to **Nusa Lembongan Island**. Discover the **Underground house at Gala Gala**, walk across the **Yellow Love Bridge**. Take a boat ride, explorer the **mangrove forest**. Then, continue visit the beautiful **Devil’s Tears** and **Dream Beach**. After lunch, take a speed boat back to Sanur Beach (journey approximately 30 mins.). Enjoy 2 hours Balinese Relaxation Spa.
- 04 BALI – DEPARTURE (Breakfast)**
Visit local fresh coffee at the **Domba Caffee Factory** and enjoy shopping at Krisna Oleh Oleh Souvenir Outlet (if time permitted). Depart Bali, private transfer to airport.

HOTEL DESCRIPTION (for guideline only)

BALI



PARK REGIS KUTA – 4★

Jl. Raya Kuta No.88, Kuta, Kabupaten Badung, Bali 80361, Indonesia

Tel: +62 361 763888

<https://www.parkregiskuta.com/>

175 rooms. Park Regis Kuta just a 10-minute drive from Ngurah Rai International Airport. Walking distance to main beach, shopping districts and restaurant.



RHADANA KUTA (Muslim Hotel) – 4★

Jalan Raya Kuta No.88, Kuta, Kabupaten Badung, Bali 80361, Indonesia

Tel: +62 361 755264

<http://www.rhadana.com/>

74 room. Situated a 10-minute drive from Kuta Beach, Discovery Mall, Bali Galeria Mall and Seminyak's hotspots. Ngurah Rai International Airport is a 20-minute drive away.

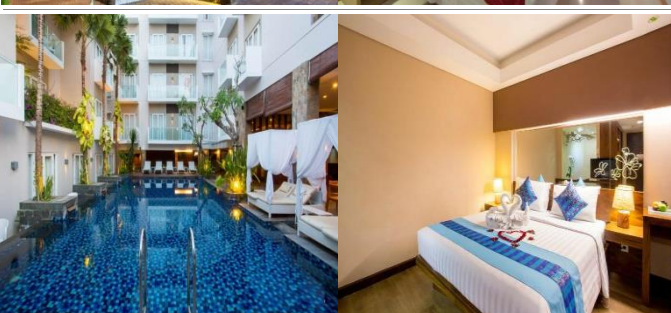

GRAND IXORA KUTA – 4★

Jl. Kartika Plaza No.92, Kuta, Kabupaten Badung, Bali 80361, Indonesia

Tel: +62 361 759099

<https://grandixora.com/>

134 rooms. 10 minutes walk from the beach. Just a 15-minute walk from Kuta Beach and the popular Discovery Shopping Mall, 6-minute drive from Ngurah Rai International Airport, while the Kuta Art Market is only a 15-minute stroll from the hotel.

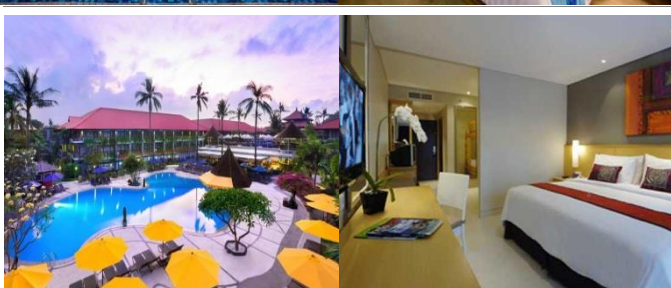

BALI DYNASTY RESORT - 5★

Jalan Kartika, Kuta, Kabupaten Badung, Bali 80361, Indonesia

Tel: +62 361 752403

<https://bdr.pphotels.com/>

313 Rooms. Located 1 minute walk from the beach. Situated within walking distance of central Kuta. Kuta Art Market is 800 m from hotel. The property is a 10-minute drive from Ngurah Rai International Airport.

NUSA PENIDA



RING SAMETON RESORT – 3★

Jalan Raya Ped-Buyuk, Br. Bodong, Ped,, Nusa Penida Island, Ped, Nusapenida, Kabupaten Klungkung, Bali 80771, Indonesia

Tel: +62 366 5581521

<http://www.ringsameton-nusapenida.com/>

32 rooms. Located 30 minutes' drive from Giri Putri Cave Temple and 30 minutes' boat ride from Nusa Penida Harbour. It is 45 minutes' drive from Ngurah Rai International Airport.

TERMS & CONDITIONS

Passengers are deemed to have read, understood and accepted the following:-

Package Price

Quoted in Ringgit Malaysia (RM) and subject to exchange rate fluctuations. Validity of prices is seasonal and subject to change without prior notice. Child rates are applicable when child is occupying a room with at least two adults.

Deposit & Payment

A deposit of RM200 per person is required when booking is made. Receipt for deposit is valid for three (3) months from the date of issue. The deposit forms part of your final payment. Balance (final payment) must be made 15 days prior to departure. Failure to comply with this may result in an automatic cancellation of your reservations and forfeiture of your deposit.

Accommodation

Bedding varies from hotel to hotel, but the following usually applies:-

Single Occupancy: comprises 1 Queen/1 Twin Bed

Double Occupancy: comprises 1 Queen/King Bed

Twin Occupancy: comprises 2 Single Beds

Triple Occupancy: comprises 3 Single / 1 Double + Rollaway Bed

If a rollaway bed is required, an extra charge applies. Most hotels will not put more than one rollaway in a room. Baby cots can be requested in advance and if extra charge applies, passenger must pay directly to hotel.

Gratuities: Included

Hotel Check-In/Out Times : Standard check-in time is after 1500hrs and check-out is before 1100hrs

Amendment Charges

An administrative fee of RM100 will be charged for each subsequent amendment made after the confirmation. Any other cost arising from the amendment will be borne by the passenger. No amendment can be made within 15 days prior to departure. A change on the entire booking is considered a cancellation and is subject to cancellation charges.

Cancellation Charges

You may cancel your booking at any time. Cancellation must be made in writing to avoid any misunderstanding. If your cancellation is received by the Company more than 30 days prior to your departure, an administration fee of RM100 per person will be levied. If your notice of cancellation is received fewer than 30 days prior to departure, the following cancellation charges will apply:

Cancellation Received Cancellation Fee

Between 29 to 16 days prior to departure: 30% of tour price

Between 15 to 08 days prior to departure: 50% of tour price

Between 7 days to departure day (No-Show): 100% of tour price

Refund

No refund will be made for unused tickets or any other unutilized portion of the inclusions. Request for refund as a result of changes to the package must be made in writing and an administrative fee of RM100 per person applies in addition to the supplier's cancellation fee. Refunds are payable only through the original booking agent.

General Information

The company reserves the right to substitute or alter similarly-priced accommodation, services and itineraries when necessary and there shall be no refund in such situation.

Responsibility

The company acts only as an agent and does not manage, control or operate any suppliers of services. The Company assumes no liability for any loss, injury, damage, accident, delay or irregularity which may be caused by these events – Acts of God, natural disasters, civil & military disorders, industrial disputes and any cause beyond the reasonable control of any company or person engaged in carrying out the arrangements made.

Reservations

All reservations are subject to space availability and confirmation.

Customer's Responsibilities

- Travel Insurance – to cover medical expenses arising through illness or accident prior to or during the holiday, and loss of the holiday and loss of holiday monies, cancellation or curtailment of holiday for insurable reasons.
- Passport & Visas – to be in possession of a valid passport and whatever necessary immigration documentation may be required by the country(ies) for the duration of the holiday.

Visa Application

Tourist visa is not required for Malaysian passport for a stay up to 30days.